

KARMA Acoustic TripleMat

Karma Acoustic TripleMat is an acoustic underlay product for use on refurbishment and remedial timber floors. It consists of polyurethane foam sandwiched between two layers of heavy rubber barrier mat, providing excellent impact and airborne sound insulation. The product is ideal for use underneath a carpet, providing airborne & impact sound insulation and a carpet underlay in a single layer, which offers considerable savings in labour and time.

It is important to use the 6mm Karma Acoustic TripleMat Gripper Strips prior to installing the traditional gripper rod. This is used to bring the perimeter of the room up to the same level as the new carpet.

Karma Acoustic TripleMat Adhesive is also recommended to bond the product to the floorboards. The adhesive can be used to bond the TripleMat to plywood when using other floor finishes such as vinyl, linoleum, carpet tiles, laminate or engineered wood.

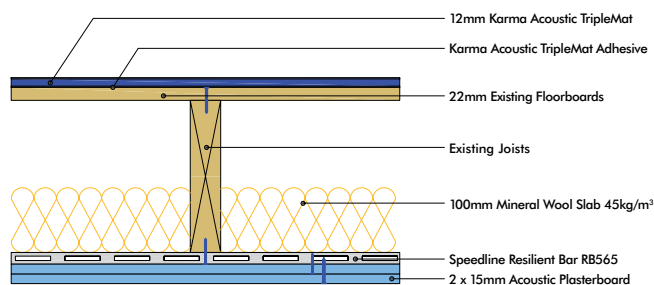

PRODUCT DESCRIPTION	IMPACT PERFORMANCE L'_{nw}	AIRBORNE PERFORMANCE $R_w + C_{tr}$
12mm Karma Acoustic TripleMat	49 dB	48 dB

Dimensions: 12mm x 1000mm x 1200mm

Benefits

- Made from 100% recycled materials
- Provides excellent impact and airborne attenuation in a single product
- When used as a carpet underlay it can upgrade a floor without increasing the height this avoids common problems with having to re-house electrical services, door thresholds and staircases
- Can be used with a variety of floor finishes

Typical Applications

- Any timber floor board refurbishment or remedial floor project where problems with noise have been encountered
- Domestic and commercial upgrades where footsteps have been a problem
- Refurbishment projects where there is no access from the ceiling side but only minimal room on the floorboards
- Material change of use Approved Document E projects when used with an appropriately insulated ceiling
- Could also be used on concrete or new build floors

Timber Soft Floor Covering Solution

A technical installation guide and CAD drawings can be downloaded from www.karma-acoustics.co.uk

