

| PRODUCT DESCRIPTION | IMPACT PERFORMANCE $L'_{nT,w}$ | AIRBORNE PERFORMANCE $D_{nT,w} + C_{tr}$ |
|--------------------------------|-----------------------------------|---|
| 15mm Karma Acoustic MultiPanel | 53 dB | 60 (-6) dB |

NB – Pre-completion testing requirements for separating floors in England and Wales are different to Scotland. See pages 4-6 of this guide.

KARMA ACOUSTIC MULTIPANEL

Karma Acoustic MultiPanel is suitable for use on refurbishment timber floor projects, reducing airborne and impact sound through floors, using a heavy material isolated by a wood fibre resilient layer.



KARMA ACOUSTIC MULTIPANEL

- Consists of a 12mm tongued and grooved cement particle board, laminated to an 18mm wood fibre resilient layer
- Can be used in all areas of the build including kitchens and bathrooms
- Can be used with any floor finish
- Provides airborne and impact sound insulation in a single product
- Dimensions 30mm x 585mm x 1185mm

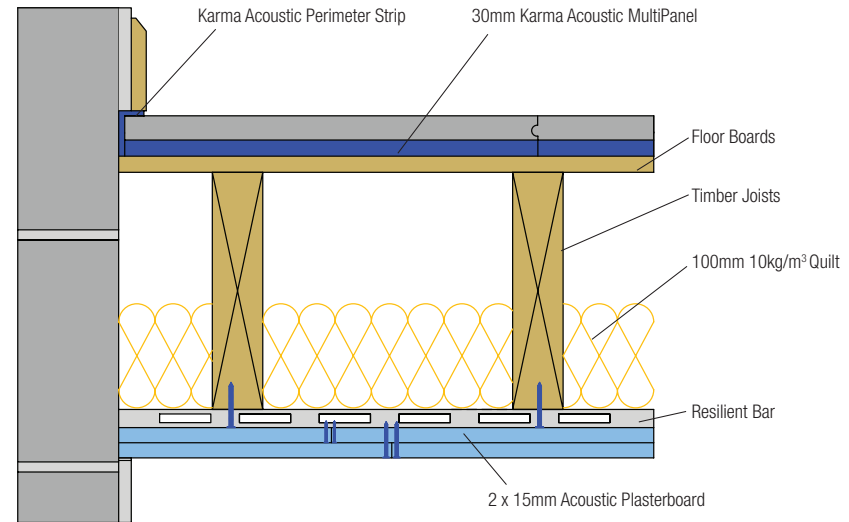

Solution Ref: KF-013

BENEFITS

- Minimal increase in floor height so existing ceiling and finishes can be maintained
- Can be installed from one side causing minimal disruption
- Provides excellent levels of airborne and impact sound attenuation, as well as exceptional levels of fire and smoke protection
- Due to small footprint, problems associated with marrying new floors up to stairwells and lifting skirting boards are alleviated
- Quick and easy to install
- Can be laid with a variety of floor finishes
- Non-load bearing partitions can be built off the floating floor surface

TYPICAL APPLICATIONS

- Refurbishment projects on mixed use developments such as retail outlets with apartments above
- Wherever access is only available from one side and a high acoustic performance is required