

# CONCRETE BATTEN FFT-1 & FFT-3 SOLUTION

- NB • RF • RD •
- GC • PCT • BBA •
- SUS • CAD

PRODUCT DESCRIPTION	IMPACT PERFORMANCE $\Delta L_w$
Karma Acoustic Batten	24 dB
Karma Acoustic BattenPlus	27 dB

NB – requirement on RD concrete floor is  $\Delta L_w$  17dB, as shown in Appendix D. Requirement in Scotland is  $\Delta L_w$  25dB, as shown in appendix 5.B – Scottish Guidance Construction 5.1.9 Floor Type 2 Floating Layer F1. Results found have been tested in accordance with Robust Details Appendix D.

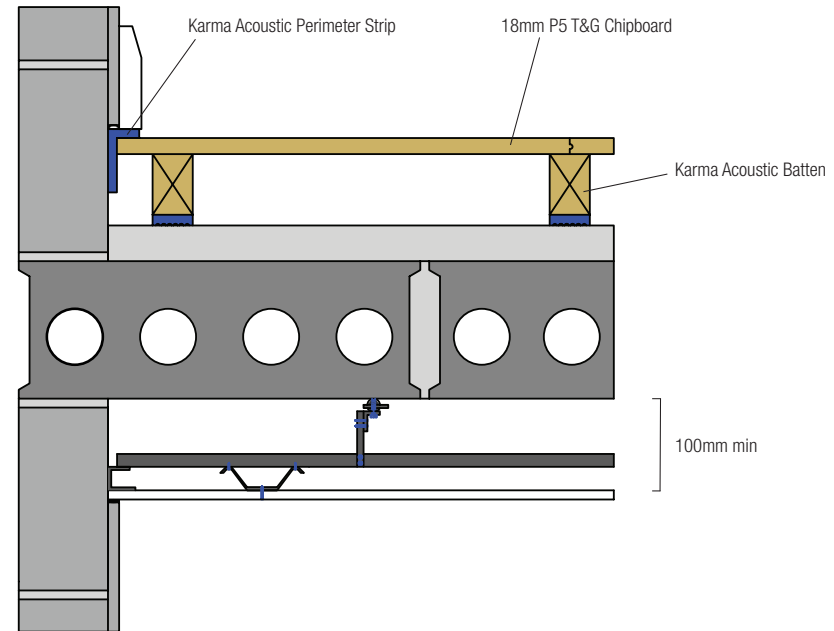

## ACOUSTIC BATTENS

Acoustic battens are designed to fit a variety of floating floor applications and the battens in the Karma Acoustic range are fully Robust Details BBA certified.

**This solution may comprise either the Karma Acoustic Batten or Karma Acoustic BattenPlus.**



### KARMA ACOUSTIC BATTEN

- The batten consists of timber, laminated to 100% recycled closed cell, non-cross-linked foam
- Due to the high compressive strength of the batten, non-loadbearing internal partitions can be built off the floating floor, as detailed in Appendix A of Robust Details
- A damp proof membrane is not required as the foam is impermeable to water
- Dimensions 55mm, 70mm or 80mm x 45mm x 2400mm



### KARMA ACOUSTIC BATTENPLUS

- The batten consists of timber, laminated to a 100% recycled chip foam
- Due to the high compressive strength of the batten, non-loadbearing internal partitions can be built off the floating floor, as detailed in Appendix A of Robust Details
- Dimensions 53mm, 75mm or 78mm x 45mm x 2400mm

### Solution Ref: KF-001

#### BENEFITS

- Exact quantity take-offs and installation plans can be provided, as per the dimensions on the drawings provided
- Minimal component range, resulting in cost-effective solutions
- No specialist tools required
- Easy to handle, conforms to site weight regulations
- Lightweight partitions can be built off the floating floor
- Karma Acoustic battens are Robust Details BBA Certified
- The voids in between the battens provide space to run services

#### TYPICAL APPLICATIONS

- New build or refurbishment concrete builds
- Apartments including professional and student accommodation and hotels
- Robust Details floor option E-FC-1, E-FC-2, E-FC-7, E-FS-1 or E-FS-2